

The **Geobrugg marshal post** is designed to protect marshals and track workers around the circuit. Its unique design offers a very good level of protection whilst maintaining the flexibility of moving the marshal post around your circuit for different configurations.

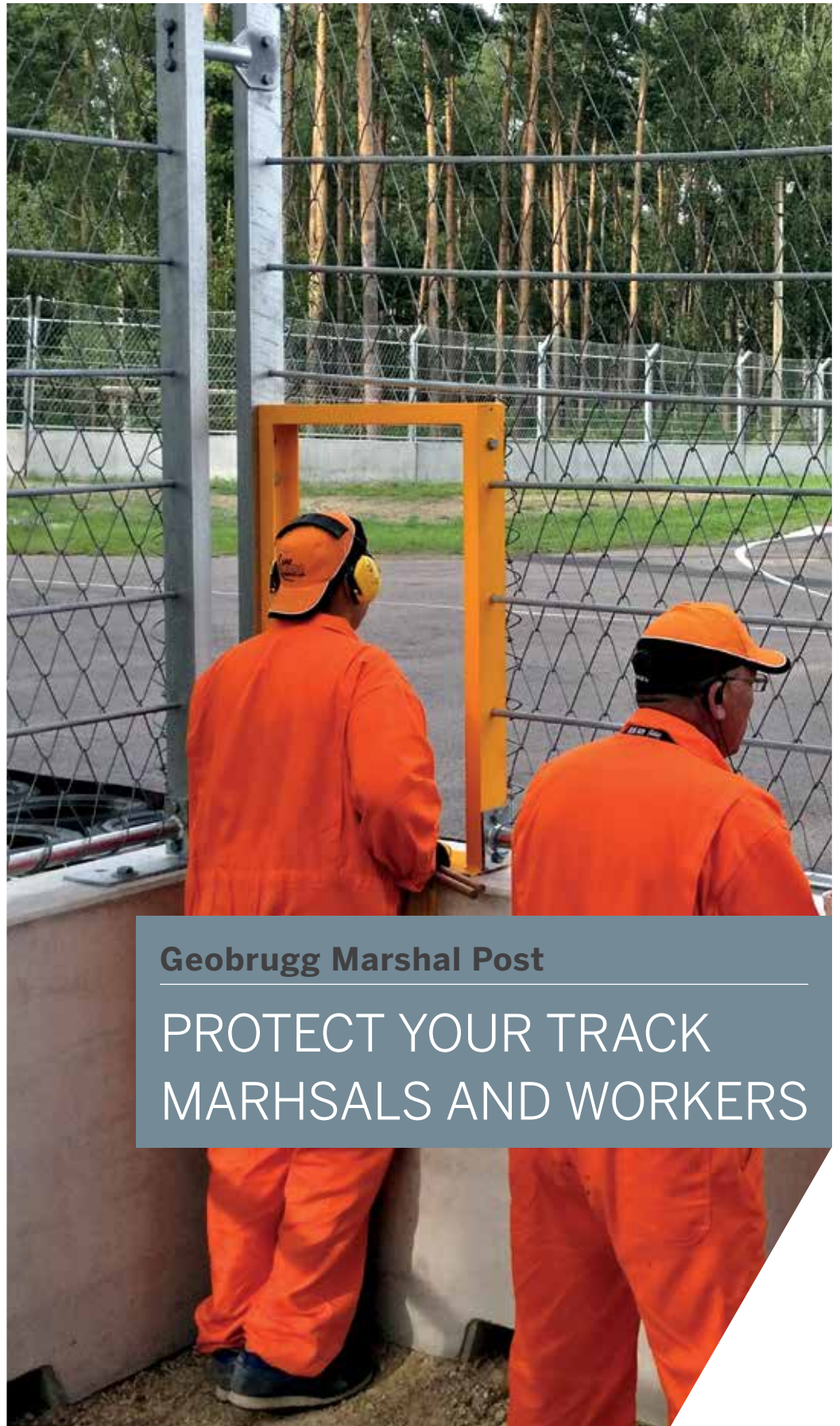

## Geobrugg Marshal Post

PROTECT YOUR TRACK  
MARSHALS AND WORKERS

# GEOBRUGG MARSHAL POST – THE FLEXIBLE SOLUTION FOR YOUR RACE TRACK.

The **marshal post** consists of one solid **NORDBETON concrete base** with special Geobruigg marshal post debris fence panels. The track side facing panel has two openings for marshals allowing flag operations or a fast response in case of an accident.

As a stand-alone solution the marshal post **can be installed free standing or behind a guardrail**. For the free standing solution make sure the marshal post is protected additionally with tire six packs.

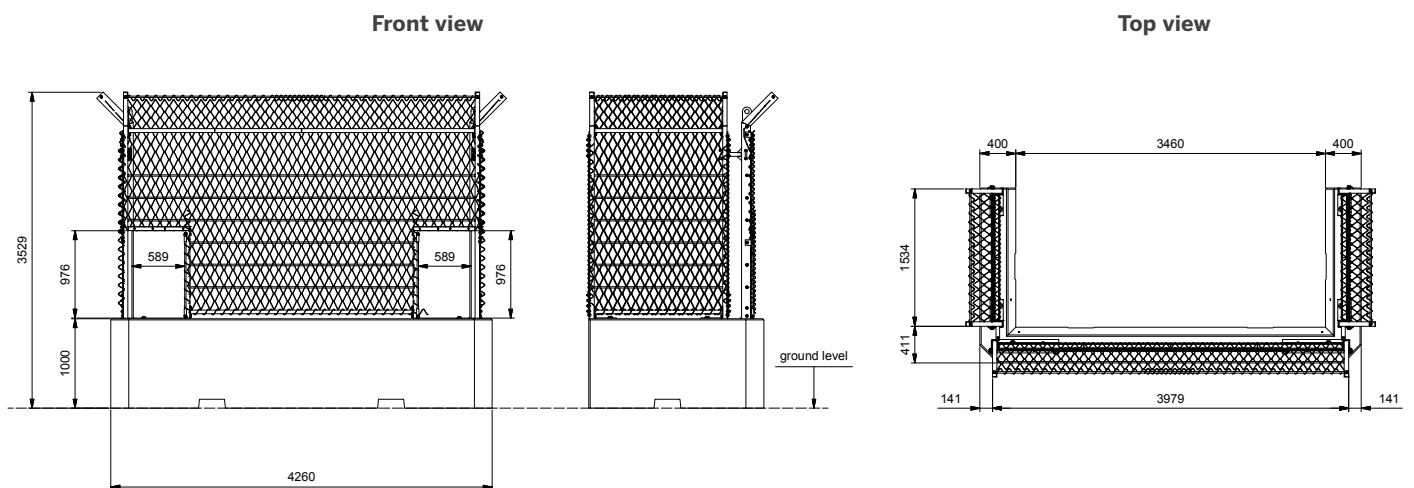

## The Geobruigg marshal post provides the following features:



### High-tensile steel wire net

The mesh made out of high-tensile steel wire with a tensile strength of  $\geq 1,770$  N/mm<sup>2</sup>, enables maximum energy absorption with minimum deformation.



### FIA accepted

Our barriers are installed at FIA and FIM homologated circuits around the world.



### Rapid installation

Our solutions are based on a plug and play principle. Installation manuals or movies make it easy to do the installation.



### Relocatable

Our design enables to easy relocate the marshal post in case of circuit modifications.



Find additional projects in our project database:  
[www.geobruigg.com/projects](http://www.geobruigg.com/projects)



**Geobruigg AG**  
Aachstrasse 11 | 8590 Romanshorn | Switzerland  
[www.geobruigg.com](http://www.geobruigg.com)

A company of the BRUGG Group  
ISO 9001 certified